

3.1 GTO Snubber Capacitors :

STG series

Applications :

GTO Snubbing and protection, Thyristor controlled rectifier circuits, High Current Snubber circuit, damping of voltage spikes on GTO-Thyristor.

Traction application and Static Drive, Pulsed Lasers, Medium Frequency tuning High ripple current and high dv/dt application.

Properties :

Very Low ESR, medium frequency range, High RMS Current Rating, High Pulse Current Rating dv/dt, High Voltage Capabilities, Temperature up to 105C, High Insulation Resistance and Flame Retardant Construction

Electrical Characteristics :

Rated Voltage : 400Vndc – 5,800Vndc / 160Vrms – 2,000Vrms
Capacitance range : 0.15 - 220uF (can be customized)

Ripple RMS Current up to 80A

Other Electrical Characteristics :

Capacitance Tolerance : +/-5%; +/-10%

Operating Temperature : +45C / +55C / +70C / +85C / +105C
(depends on capacitor raw materials)

Testing Voltage Terminal to Terminal : Vsurge 10 sec (can be customized)

Testing Voltage Terminal to Case : 4500Vac at 105C 1min.
Support higher voltage requirement

Insulation Resistance :250Vdc +25C >= 300,000Mohm
250Vdc +85C >= 50,000Mohm
250Vdc +105C >= 5,000Mohm

Ultra-Low Leakage version is available on request

Reference Standard : IEC61071

Specifications and Size :

STG-A Vndc = 400V / Vrms = 160Vac / Vpeak = 230V 10s / Vsurge = 650V 30s/day

P/N :	C _n uF	Diameter D mm	Length L mm	ESR mohm 100khz	ESL nH	dv/dt v/us	Peak Current I _{peak} A	Max. Amp 70C	Max. Amp 85C	d (mm)
STG-A336J400D	33	65	58	2.2	38	25	800	45	21	M6
STG-A506J400D	50	90	58	1.8	38	25	1200	60	27	M8
STG-A756J400D	75	90	58	1.5	38	25	1800	70	33	M8
STG-A107J400D	100	90	58	1.6	38	25	2500	70	31	M8
STG-A117J400D	110	90	58	1.6	38	25	2700	70	34	M8
STG-A227J400D	220	90	96	1.9	80	12	2600	70	31	M8

STG-A Vndc = 600V / Vrms = 220Vac / Vpeak = 310V 10s / Vsurge = 900V 30s/day

P/N :	C _n uF	Diameter D mm	Length L mm	ESR mohm 100khz	ESL nH	dv/dt v/us	Peak Current I _{peak} A	Max. Amp 70C	Max. Amp 85C	d (mm)
STG-A336J600D	33	90	58	1.7	38	50	1600	47	25	M8
STG-A506J600D	50	90	58	1.6	38	50	2500	62	33	M8
STG-A107J600D	100	90	96	2.5	80	22	2200	57	30	M8

STG-A Vndc = 700V / Vrms = 250Vac / Vpeak = 350V 10s / Vsurge = 1100V 30s/day

P/N :	C _n uF	Diameter D mm	Length L mm	ESR mohm 100khz	ESL nH	dv/dt v/us	Peak Current I _{peak} A	Max. Amp 70C	Max. Amp 85C	D (mm)
STG-A206J700D	20	90	58	1.7	38	60	1200	46	35	M6
STG-A256J700D	25	90	58	1.6	38	60	1500	58	43	M8
STG-A336J700D	33	90	58	1.4	38	60	2000	62	47	M8
STG-A506J700D	50	90	96	2.6	80	25	1200	48	36	M8

STG-01A Vndc = 700V / Vrms = 250Vac / Vpeak = 360V 10s / Vsurge = 1000V 30s/day

P/N :	C _n uF	Diameter D mm	Length L mm	ESR mohm 100khz	ESL nH	dv/dt v/us	Peak Current I _{peak} A	Max. Amp 70C	Max. Amp 85C	Max. Amp 105C	d (mm)
STG-01A126K700D	12	90	63.5	2.6	10	320	3800	60	55	40	M6
STG-01A156K700D	15	90	63.5	2.5	10	320	4800	60	55	40	M6
STG-01A206K700D	20	90	81	2.6	12	190	3800	60	55	40	M6
STG-01A226K700D	22	90	81	2.4	12	190	4200	60	55	40	M6
STG-01A256K700D	25	90	99	2.7	15	130	3300	60	55	40	M6
STG-01A306K700D	30	90	99	2.5	15	130	4000	60	55	40	M6
STG-01A356K700D	35	90	99	2.2	15	130	4600	60	55	40	M6
STG-01A406K700D	40	90	134	2.4	22	80	3400	60	55	40	M6
STG-01A456K700D	45	90	134	2.2	22	80	3900	70	65	45	M6
STG-01A506K700D	50	90	134	2.1	22	80	4300	70	65	45	M6

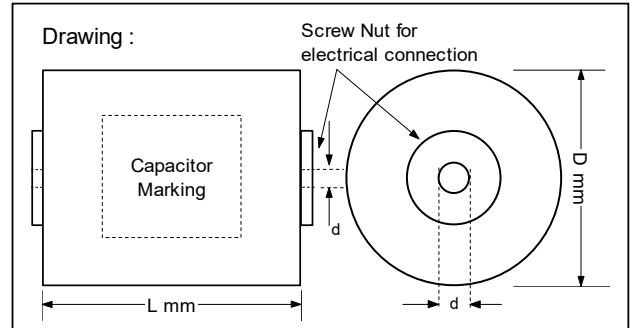

STG-01A V_{ndc} = 850V / V_{rms} = 320Vac / V_{peak} = 450V 10s / V_{surge} = 1300V 30s/day

P/N :	C _n uF	Diameter D mm	Length L mm	ESR mohm 100khz	ESL nH	dv/dt v/us	Peak Current I _{peak} A	Max. Amp 45C	Max. Amp 55C	Max. Amp 70C	Max. Amp 85C	d (mm)
STG-01A205J850D	2	65	50	1.5	11	800	1600	38	30	20	12	M6
STG-01A225J850D	2.2	65	50	1.5	11	800	1700	40	35	23	13	M6
STG-01A255J850D	2.5	65	50	1.2	11	800	2000	45	38	25	15	M6
STG-01A305J850D	3	65	50	1.2	11	800	2400	55	45	30	18	M6
STG-01A405J850D	4	65	50	1.0	11	800	3200	70	60	40	25	M6
STG-01A505J850D	5	65	50	1.0	11	800	4000	80	70	50	30	M6
STG-01A605J850D	6	65	62	1.0	15	440	2600	60	50	35	20	M6
STG-01A805J850D	8	65	62	0.8	15	440	3500	80	70	45	25	M6

STG-A V_{ndc} = 850V / V_{rms} = 330Vac / V_{peak} = 470V 10s / V_{surge} = 1300V 30s/day

P/N :	C _n uF	Diameter D mm	Length L mm	ESR mohm 100khz	ESL nH	dv/dt v/us	Peak Current I _{peak} A	Max. Amp 70C	Max. Amp 85C	Max. Amp 105C	d (mm)
STG-A256J850D	25	90	62	1.6	38	80	2000	65	49	35	M6
STG-A606J850D	60	90	92	2.5	80	30	1800	56	42	30	M6

STG-01A V_{ndc} = 900V / V_{rms} = 280Vac / V_{peak} = 400V 10s / V_{surge} = 1440V 10s/day

P/N :	C _n uF	Diameter D mm	Length L mm	ESR mohm 100khz	ESL nH	dv/dt v/us	Peak Current I _{peak} A	Max. Amp 70C	Max. Amp 85C	Max. Amp 105C	d (mm)
STG-01A225J900D	2.2	65	100	2.2	20	720	1500	35	30	10	M6
STG-01A335J900D	3.3	65	100	2.4	20	400	1300	30	25	9	M6
STG-01A475J900D	4.7	65	100	2.3	20	400	1900	35	30	10	M6
STG-01A685J900D	6.8	90	100	2.0	20	300	2000	40	35	15	M6
STG-01A106J900D	10	90	100	1.9	20	300	3000	45	50	17	M8
STG-01A156J900D	15	90	100	1.7	20	250	3700	50	50	17	M8
STG-01A226K900D	22	90	165	2.0	25	250	5500	60	55	25	M8
STG-01A336K900D	33	90	225	2.0	30	250	8200	80	60	30	M8
STG-01A406K900D-V1	40	90	225	1.7	30	250	10000	80	70	40	M8
STG-01A506K900D	50	90	293	1.9	40	250	12500	80	70	40	M8
STG-01A606K900D	60	90	293	1.7	40	250	15000	80	70	40	M8

STG-01A V_{ndc} = 900V / V_{rms} = 320Vac / V_{peak} = 450V 10s / V_{surge} = 1260V 30s/day

P/N :	C _n uF	Diameter D mm	Length L mm	ESR mohm 100khz	ESL nH	dv/dt v/us	Peak Current I _{peak} A	Max. Amp 70C	Max. Amp 85C	Max. Amp 105C	d (mm)
STG-01A805K900D	8	65	81	2.8	12	280	2200	45	40	30	M6
STG-01A106K900D	10	65	81	2.7	12	280	2800	45	40	30	M6
STG-01A126K900D	12	65	99	2.6	15	190	2300	45	40	30	M6
STG-01A156K900D	15	65	99	2.5	15	190	2900	50	45	35	M6
STG-01A186K900D	18	90	99	2.4	15	190	3500	50	45	35	M6
STG-01A206K900D	20	65	134	2.5	22	120	2500	50	45	35	M6
STG-01A256K900D	25	90	134	2.4	22	120	3100	60	55	40	M6
STG-01A306K900D	30	90	134	2.3	22	120	3800	70	65	50	M6
STG-01A356K900D	35	90	134	2.2	22	120	4400	70	65	50	M6
STG-01A406K900D-V2	40	90	134	2.1	22	120	5000	70	65	50	M6

STG-01A V_{ndc} = 1000V / V_{rms} = 300Vac / V_{peak} = 450V 10s / V_{surge} = 1600V 10s/day

P/N :	C _n uF	Diameter D mm	Length L mm	ESR mohm 100khz	ESL nH	dv/dt v/us	Peak Current I _{peak} A	Max. Amp 70C	Max. Amp 85C	Max. Amp 105C	d (mm)
STG-01A225J1000D	2.2	65	100	2.2	20	880	1900	35	30	13	M6
STG-01A335J1000D	3.3	65	100	2.4	20	490	1600	30	25	11	M6
STG-01A475J1000D	4.7	65	100	2.0	20	490	2300	40	35	15	M6
STG-01A685J1000D	6.8	90	100	2.0	20	400	2700	40	40	18	M6
STG-01A755J1000D	7.5	90	100	1.7	20	400	3000	45	45	20	M8
STG-01A106J1000D	10	90	100	1.7	20	300	3000	45	45	20	M8
STG-01A126K1000D	12	90	165	1.9	29	300	3600	50	45	20	M8
STG-01A156K1000D	15	90	165	1.9	29	300	4500	60	50	25	M8
STG-01A226K1000D	22	90	165	1.7	35	300	6600	70	60	30	M8
STG-01A256K1000D	25	90	225	1.9	23	300	7500	80	55	25	M8
STG-01A306K1000D	30	90	225	1.7	23	300	9000	80	60	30	M8
STG-01A336K1000D	33	90	225	1.7	23	300	9900	80	70	35	M8
STG-01A356K1000D	35	90	293	1.9	18	300	10500	80	70	35	M8
STG-01A406K1000D	40	90	293	1.7	18	300	12000	80	70	35	M8

For other Capacitance, Voltage, dv/dt, Peak Current and RMS Current not listed, please contact us for a suggestion.

STG-01A V_{ndc} = 1100V / V_{rms} = 370Vac / V_{peak} = 525V 10s / V_{surge} = 1680V 10s/day

P/N :	C _n uF	Diameter D mm	Length L mm	ESR mohm 100khz	ESL nH	dv/dt v/us	Peak Current I _{peak} A	Max. Amp 70C	Max. Amp 85C	Max. Amp 105C	d (mm)
STG-01A605K1100D	6	65	81	2.7	12	420	2500	45	40	30	M6
STG-01A805K1100D	8	90	81	2.5	12	420	3400	55	50	40	M6
STG-01A106K1100D	10	90	81	2.2	12	420	4200	70	65	55	M6
STG-01A126K1100D	12	90	99	2.2	15	290	3502	70	65	55	M6
STG-01A156K1100D	15	90	134	2.4	22	190	2800	50	45	35	M6
STG-01A186K1100D	18	90	134	2.3	22	190	3400	55	50	40	M6
STG-01A206K1100D	20	90	134	2.2	22	190	3800	65	60	45	M6
STG-01A226K1100D	22	90	134	2.1	22	190	4200	70	65	50	M6
STG-01A256K1100D	25	90	134	1.9	22	190	4800	70	65	50	M6

STG-01A V_{ndc} = 1200V / V_{rms} = 390Vac / V_{peak} = 550V 10s / V_{surge} = 1800V 30s/day

P/N :	C _n uF	Diameter D mm	Length L mm	ESR mohm 100khz	ESL nH	dv/dt v/us	Peak Current I _{peak} A	Max. Amp 45C	Max. Amp 55C	Max. Amp 70C	Max. Amp 85C	d (mm)
STG-01A105J1200D	1	65	50	1.6	11	1200	1200	30	25	16.5	10	M6
STG-01A155J1200D	1.5	65	50	1.5	11	1200	1800	45	35	25	15	M6
STG-01A205J1200D	2	65	50	1.2	11	1200	2400	60	50	33	18	M6
STG-01A225J1200D	2.2	65	50	1.2	11	1200	2600	65	55	35	20	M6
STG-01A255J1200D	2.5	65	62	1.2	15	620	1500	70	35	23	13	M6
STG-01A305J1200D	3	65	62	1.0	15	620	1800	50	40	27	16	M6
STG-01A355J1200D	3.5	65	62	1.0	15	620	2100	55	45	30	18	M6
STG-01A405J1200D	4	65	62	0.8	15	620	2400	65	55	35	22	M6

STG-01A V_{ndc} = 1200V / V_{rms} = 390Vac / V_{peak} = 550V 10s / V_{surge} = 1950V 30s/day

P/N :	C _n uF	Diameter D mm	Length L mm	ESR mohm 100khz	ESL nH	dv/dt v/us	Peak Current I _{peak} A	Max. Amp 85C	Max. Amp 105C	d (mm)
STG-01A205K1200D-C6x	2	65	120	2.4	34.2	1220	2400	25	16.5	M6
STG-01A255K1200D-C6x	2.5	65	130	2.3	34.2	1220	3000	35	20	M6
STG-01A335K1200D-C6x	3.3	65	160	1.8	22.8	1220	4000	35	20	M6
STG-01A355K1200D-C6x	3.5	65	165	1.7	22.8	1220	4200	35	20	M6
STG-01A405K1200D-C6x	4	65	145	2.2	22.8	680	2700	25	15	M6
STG-01A505K1200D-C6x	5	65	215	1.9	17.1	1220	6100	50	30	M6
STG-01A605K1200D-C6x	6	65	185	2.1	17.1	680	4000	35	20	M6
STG-01A805K1200D-C6x	8	90	165	2.0	22.8	520	4100	40	23	M6
STG-01A106K1200D-C6x	10	90	180	1.9	22.8	520	5200	60	28	M8
STG-01A126K1200D-C6x	12	90	190	1.8	22.8	520	6200	60	35	M8
STG-01A156K1200D-C6x	15	90	245	1.8	17.1	520	7800	60	35	M8
STG-01A106K1200D-C6x	18	90	245	1.9	17.1	400	7200	60	35	M8
STG-01A106K1200D-C6x	20	90	245	1.8	17.1	400	8000	60	40	M8
STG-01A106K1200D-C6x	22	90	245	1.7	17.1	400	8800	60	40	M8

STG-A V_{ndc} = 1200V / V_{rms} = 440Vac / V_{peak} = 630V 10s / V_{surge} = 1800V 30s/day

P/N :	C _n uF	Diameter r D mm	Length L mm	ESR mohm 100khz	ESL nH	dv/dt v/us	Peak Current I _{peak} A	Max. Amp 70C	Max. Amp 85C	d (mm)
STG-A255J1200D	2.5	65	58	1.8	25	300	750	45	40	M8
STG-A305J1200D	3	65	58	1.7	25	300	900	50	46	M8
STG-A505J1200D	5	90	58	1.6	25	300	1500	70	53	M8
STG-A605J1200D	6	90	58	1.5	25	300	1800	70	64	M8

STG-01A V_{ndc} = 1300V / V_{rms} = 400Vac / V_{peak} = 580V 10s / V_{surge} = 2100V 10s/day

P/N :	C _n uF	Diameter D mm	Length L mm	ESR mohm 100khz	ESL nH	dv/dt v/us	Peak Current I _{peak} A	Max. Amp 70C	Max. Amp 85C	Max. Amp 105C	d (mm)
STG-01A225J1300D	2.2	65	100	2.3	20	680	1500	30	20	12	M6
STG-01A335J1300D	3.3	90	100	1.7	20	520	1700	40	30	14	M8
STG-01A475J1300D	4.7	90	100	1.8	20	520	2400	45	30	20	M8
STG-01A685J1300D	6.8	90	165	2.2	25	520	3500	50	35	20	M8
STG-01A755K1300D	7.5	90	165	1.9	29	520	3900	50	40	20	M8
STG-01A106K1300D	10	90	165	1.9	35	400	4000	55	40	20	M8
STG-01A126K1300D	12	90	165	1.7	35	400	4800	60	45	25	M8
STG-01A156K1300D	15	90	225	1.9	23	400	6000	70	45	25	M8
STG-01A206K1300D	20	90	293	1.9	18	400	8000	80	60	30	M8
STG-01A226K1300D	22	90	293	1.7	18	400	8800	80	60	30	M8
STG-01A256K1300D	25	90	293	1.7	18	400	10000	80	70	35	M8

For other Capacitance, Voltage, dv/dt, Peak Current and RMS Current not listed, please contact us for a suggestion.

STG-A V_{ndc} = 1400V / V_{rms} = 500Vac / V_{peak} = 700V 10s / V_{surge} = 2100V 30s/day

P/N :	C _n uF	Diameter D mm	Length L mm	ESR mohm 100khz	ESL nH	dv/dt v/us	Peak Current I _{peak} A	Max. Amp 55C	Max. Amp 70C	Max. Amp 85C	d (mm)
STG-A225J1400D	2.2	65	56	2.0	8.5	530	1100	33	28	23	M6
STG-A255J1400D	2.5	65	56	1.8	8.5	530	1300	37	32	27	M6
STG-A305J1400D	3	65	56	1.8	8.5	530	1600	37	32	25	M6
STG-A405J1400D	4	65	56	1.5	8.5	530	2100	45	40	33	M6
STG-A505J1400D	5	90	56	1.4	8.5	530	2600	60	50	40	M6
STG-A605J1400D	6	90	56	1.2	8.5	530	3200	70	60	50	M8
STG-A705J1400D	7	90	56	1.1	8.5	530	3700	70	60	50	M8
STG-A805J1400D	8	90	56	0.9	8.5	530	4200	70	60	50	M8

STG-01A V_{ndc} = 1500V / V_{rms} = 450Vac / V_{peak} = 640V 10s / V_{surge} = 2400V 10s/day

P/N :	C _n uF	Diameter D mm	Length L mm	ESR mohm 100khz	ESL nH	dv/dt v/us	Peak Current I _{peak} A	Max. Amp 70C	Max. Amp 85C	Max. Amp 105C	d (mm)
STG-01A225J1500D	2.2	90	100	1.9	20	660	1400	35	30	7	M6
STG-01A335J1500D	3.3	90	100	1.7	20	660	2100	40	35	8	M6
STG-01A405J1500D	4	90	100	1.7	20	500	2000	40	35	8	M6
STG-01A455J1500D	4.5	90	100	1.7	20	500	2200	45	35	9	M8
STG-01A685K1500D	6.8	90	165	1.7	29	500	3400	55	50	14	M8
STG-01A755K1500D	7.5	90	165	1.8	35	500	3700	55	45	14	M8
STG-01A106K1500D-V1	10	90	225	1.8	23	500	5000	70	60	18	M8
STG-01A126K1500D-V1	12	90	225	1.7	23	500	6000	70	55	18	M8
STG-01A156K1500D-V1	15	90	293	1.8	18	500	7500	80	60	20	M8
STG-01A186K1500D	18	90	293	1.7	18	500	9000	80	70	20	M8

STG-01A V_{ndc} = 1500V / V_{rms} = 400Vac / V_{peak} = 570V 10s / V_{surge} = 2100V 10s/day

P/N :	C _n uF	Diameter D mm	Length L mm	ESR mohm 100khz	ESL nH	dv/dt v/us	Peak Current I _{peak} A	Max. Amp 70C	Max. Amp 85C	Max. Amp 105C	d (mm)
STG-01A405K1500D	4	65	81	2.7	12	694	2776	40	30	20	M6
STG-01A505K1500D	5	90	81	2.5	12	694	3470	40	30	20	M6
STG-01A605K1500D	6	65	99	2.7	15	480	2880	40	30	20	M6
STG-01A805K1500D	8	90	99	2.4	15	480	3840	55	45	35	M6
STG-01A106K1500D-V2	10	90	99	2.2	15	480	4800	70	60	50	M6
STG-01A126K1500D-V2	12	90	134	2.4	22	312	3744	55	45	35	M6
STG-01A156K1500D-V2	15	90	134	2.1	22	312	4680	70	60	50	M6

STG-01A V_{ndc} = 1500V / V_{rms} = 450Vac / V_{peak} = 636V 10s / V_{surge} = 2400V 30s/day

P/N :	C _n uF	Diameter D mm	Length L mm	ESR mohm 100khz	ESL nH	dv/dt v/us	Peak Current I _{peak} A	Max. Amp 85C	Max. Amp 105C	d (mm)
STG-01A155K1500D-C6x	1.5	65	125	1.9	34.2	1500	2200	25	15	M6
STG-01A205K1500D-C6x	2	65	110	2.3	34.2	850	1700	25	15	M6
STG-01A255K1500D-C6x	2.5	65	165	1.9	22.8	1500	3700	35	25	M6
STG-01A305K1500D-C6x	3	65	145	2.3	22.8	850	2500	30	20	M6
STG-01A405K1500D-C6x	4	65	180	2.3	17.1	850	3400	30	20	M6
STG-01A505K1500D-C6x	5	90	160	1.9	22.8	660	3300	40	25	M6
STG-01A605K1500D-C6x	6	90	170	1.9	22.8	660	3960	40	25	M6
STG-01A805K1500D-C6x	8	90	195	1.7	22.8	660	5280	50	35	M6
STG-01A106K1500D-C6x	10	90	255	1.8	17.1	660	6600	60	40	M8
STG-01A126K1500D-C6x	12	90	255	1.7	17.1	660	7900	60	40	M8

STG-A V_{ndc} = 1500V / V_{rms} = 500Vac / V_{peak} = 700V 10s / V_{surge} = 2300V 30s/day

P/N :	C _n uF	Diameter D mm	Length L mm	ESR mohm 100khz	ESL nH	dv/dt v/us	Peak Current I _{peak} A	Max. Amp 70C	Max. Amp 85C	d (mm)
STG-A305J1500D	3	65	58	1.5	25	450	1300	47	33	M6
STG-A405J1500D	4	90	58	1.3	25	450	1800	63	44	M8

STG-01A V_{ndc} = 1600V / V_{rms} = 600Vac / V_{peak} = 850V 10s / V_{surge} = 2400V 30s/day

P/N :	C _n uF	Diameter D mm	Length L mm	ESR mohm 100khz	ESL nH	dv/dt v/us	Peak Current I _{peak} A	Max. Amp 45C	Max. Amp 55C	Max. Amp 70C	Max. Amp 85C	d (mm)
STG-01A684J1600D	0.68	65	50	1.6	11	1500	1000	25	21	14	8	M6
STG-01A105J1600D	1	65	50	1.5	11	1500	1500	35	30	20	12	M6
STG-01A125J1600D	1.2	65	50	1.5	11	1500	1800	45	35	25	15	M6
STG-01A155J1600D	1.5	65	50	1.5	11	1500	2200	55	45	30	18	M6
STG-01A205J1600D	2	65	62	1.2	15	840	1600	40	35	23	13	M6
STG-01A225J1600D	2.2	65	62	1.2	15	840	1800	45	35	25	15	M6
STG-01A255J1600D	2.5	65	62	1.0	15	840	2100	50	40	27	16	M6

For other Capacitance, Voltage, dv/dt, Peak Current and RMS Current not listed, please contact us for a suggestion.

STG-01A V_{ndc} = 1700V / V_{rms} = 530Vac / V_{peak} = 750V 10s / V_{surge} = 2720V 30s/day

P/N :	C _n uF	Diameter D mm	Length L mm	ESR mohm 100khz	ESL nH	dv/dt v/us	Peak Current I _{peak} A	Max. Amp 70C	Max. Amp 85C	Max. Amp 105C	d (mm)
STG-01A225K1700D	2.2	65	80	1.2	25	1200	2600	50	40	15	M6
STG-01A255K1700D	2.5	65	105	1.3	35	680	1700	50	40	15	M6
STG-01A305K1700D	3	65	105	1.5	35	680	2040	50	40	20	M6
STG-01A405K1700D	4	65	120	1.5	40	520	2080	50	40	20	M6
STG-01A505K1700D	5	65	140	1.5	50	400	2000	50	40	20	M6
STG-01A605K1700D	6	65	140	1.3	50	400	2400	60	50	25	M6

STG-01A V_{ndc} = 1700V / V_{rms} = 530Vac / V_{peak} = 740V 10s / V_{surge} = 2700V 30s/day

P/N :	C _n uF	Diameter D mm	Length L mm	ESR mohm 100khz	ESL nH	dv/dt v/us	Peak Current I _{peak} A	Max. Amp 85C	Max. Amp 105C	d (mm)
STG-01A105K1800D-C6x	1	65	120	2.3	34.2	1800	1800	25	15	M6
STG-01A125K1800D-C6x	1.2	65	130	2.2	34.2	1800	2100	25	15	M6
STG-01A155K1800D-C6x	1.5	65	160	2.3	22.8	1800	2700	25	15	M6
STG-01A205K1800D-C6x	2	65	145	2.5	22.8	1040	2000	25	15	M6
STG-01A255K1800D-C6x	2.5	65	220	2.2	17.1	1800	4500	40	25	M6
STG-01A305K1800D-C6x	3	65	185	2.6	17.1	1040	3100	40	25	M6
STG-01A355K1800D-C6x	3.5	90	140	2.0	34.2	800	2800	40	25	M6
STG-01A405K1800D-C6x	4	90	145	1.9	34.2	800	3200	40	25	M6
STG-01A505K1800D-C6x	5	90	180	2.0	22.8	800	4000	40	25	M6
STG-01A605K1800D-C6x	6	90	200	1.8	22.8	800	4800	50	30	M6
STG-01A805K1800D-C6x	8	90	200	1.7	22.8	800	6400	50	30	M6
STG-01A106K1800D-C6x	10	90	250	1.8	17.1	800	8000	50	30	M6

STG-A V_{ndc} = 1700V / V_{rms} = 650Vac / V_{peak} = 920V 10s / V_{surge} = 2600V 30s/day

P/N :	C _n uF	Diameter D mm	Length L mm	ESR mohm 100khz	ESL nH	dv/dt v/us	Peak Current I _{peak} A	Max. Amp 55C	Max. Amp 70C	Max. Amp 85C	d (mm)
STG-A205J1700D	2	65	56	1.9	8.5	845	1700	30	25	21	M6
STG-A225J1700D	2.2	65	56	1.7	8.5	845	1800	33	28	23	M6
STG-A255J1700D	2.5	65	56	1.5	8.5	845	2100	37	32	27	M6
STG-A305J1700D	3	65	56	1.3	8.5	845	2500	45	39	32	M6
STG-A405J1700D	4	90	56	1.1	8.5	845	3300	60	50	40	M6
STG-A505J1700D	5	90	56	1.0	8.5	845	4200	70	60	50	M8

STG-01A V_{ndc} = 1800V / V_{rms} = 540Vac / V_{peak} = 760V 10s / V_{surge} = 2900V 10s/day

P/N :	C _n uF	Diameter D mm	Length L mm	ESR mohm 100khz	ESL nH	dv/dt v/us	Peak Current I _{peak} A	Max. Amp 70C	Max. Amp 85C	Max. Amp 105C	d (mm)
STG-01A225J1800D	2.2	90	100	1.9	20	800	1700	35	30	15	M6
STG-01A335K1800D	3.3	90	165	2.5	29	800	2600	45	30	17	M8
STG-01A475K1800D	4.7	90	165	2.0	35	620	2900	45	30	17	M8
STG-01A685K1800D	6.8	90	225	2.0	23	620	4200	55	35	20	M8
STG-01A805K1800D-V1	8	90	225	1.8	23	620	4900	55	40	25	M8
STG-01A106K1800D-V1	10	90	293	1.8	18	620	6200	80	45	30	M8
STG-01A126K1800D-V1	12	90	293	1.7	18	620	7400	80	60	35	M8

STG-01A V_{ndc} = 1800V / V_{rms} = 440Vac / V_{peak} = 625V 10s / V_{surge} = 2520V 10s/day

P/N :	C _n uF	Diameter D mm	Length L mm	ESR mohm 100khz	ESL nH	dv/dt v/us	Peak Current I _{peak} A	Max. Amp 70C	Max. Amp 85C	Max. Amp 105C	d (mm)
STG-01A405K1800D	4	65	99	2.7	15	690	2700	35	30	20	M6
STG-01A505K1800D	5	90	99	2.5	15	690	3400	40	35	25	M6
STG-01A605K1800D	6	90	99	2.4	15	480	2800	45	40	30	M6
STG-01A805K1800D-V2	8	90	134	2.4	22	480	3800	45	40	30	M6
STG-01A106K1800D-V2	10	90	134	2.2	22	480	4800	55	50	40	M6
STG-01A126K1800D-V2	12	90	134	2.1	22	310	3700	55	50	40	M6

STG-A V_{ndc} = 1800V / V_{rms} = 600Vac / V_{peak} = 850V 10s / V_{surge} = 2700V 30s/day

P/N :	C _n uF	Diameter D mm	Length L mm	ESR mohm 100khz	ESL nH	dv/dt v/us	Peak Current I _{peak} A	Max. Amp 45C	Max. Amp 55C	Max. Amp 85C	d (mm)
STG-A405J1800D	4	65	92	5.0	55	300	1200	25	18	12	M6
STG-A475J1800D	4.7	65	92	5.0	55	300	1400	30	20	15	M6
STG-A605J1800D	6	65	92	4.5	55	300	1800	35	25	17	M6
STG-A805J1800D	8	65	92	4.5	55	200	1600	40	30	20	M6
STG-A106J1800D	10	90	92	4.0	55	300	3000	55	40	30	M6
STG-A126J1800D	12	90	92	4.0	55	260	3100	65	50	35	M6

For other Capacitance, Voltage, dv/dt, Peak Current and RMS Current not listed, please contact us for a suggestion.

STG-01A V_{ndc} = 2000V / V_{rms} = 650Vac / V_{peak} = 920V 10s / V_{surge} = 3000V 30s/day

P/N :	C _n uF	Diameter D mm	Length L mm	ESR mohm 100khz	ESL nH	dv/dt v/us	Peak Current I _{peak} A	Max. Amp 45C	Max. Amp 55C	Max. Amp 70C	Max. Amp 85C	d (mm)
STG-01A504J2000D	0.5	65	50	1.6	11	1880	940	22	18	12	7	M6
STG-01A684J2000D	0.68	65	50	1.5	11	1880	1200	30	25	17	10	M6
STG-01A105J2000D	1	65	50	1.2	11	1880	1900	45	35	25	15	M6
STG-01A125J2000D	1.2	65	62	1.6	15	1040	1200	30	25	16	10	M6
STG-01A155J2000D	1.5	65	62	1.5	15	1040	1500	35	30	30	20	M6

STG-01A V_{ndc} = 2100V / V_{rms} = 700Vac / V_{peak} = 700V 10s / V_{surge} = 3150V 10s/day

P/N :	C _n uF	Diameter D mm	Length L mm	ESR mohm 100khz	ESL nH	dv/dt v/us	Peak Current I _{peak} A	Max. Amp 70C	Max. Amp 85C	Max. Amp 105C	d (mm)
STG-01A405K2100D	4	90	153	2.4	17	1120	4500	50	40	30	M6
STG-01A505K2100D	5	90	153	2.2	17	1120	5600	65	55	45	M6
STG-01A605K2100D	6	90	190	2.1	20	780	4600	65	55	45	M6
STG-01A805K2100D	8	90	260	2.5	33	500	4000	45	35	25	M6
STG-01A106K2100D	10	90	260	2.3	33	500	5000	60	50	40	M6
STG-01A126K2100D	12	90	260	1.9	33	500	6000	70	60	50	M6

STG-A V_{ndc} = 2500V / V_{rms} = 900Vac / V_{peak} = 1270V 10s / V_{surge} = 3800V 30s/day

P/N :	C _n uF	Diameter D mm	Length L mm	ESR mohm 100khz	ESL nH	dv/dt v/us	Peak Current I _{peak} A	Max. Amp 45C	Max. Amp 55C	Max. Amp 85C	d (mm)
STG-A225J2500D	2.2	65	92	5.0	55	530	1100	25	20	15	M6
STG-A335J2500D	3.3	65	92	4.5	55	530	1700	35	25	20	M6
STG-A475J2500D	4.7	90	92	4.0	55	530	2500	50	40	30	M6
STG-A685J2500D	6.8	90	92	4.0	55	530	3600	70	55	40	M6

STG-01A V_{ndc} = 2500V / V_{rms} = 950Vac / V_{peak} = 1300V 10s / V_{surge} = 3750V 10s/day

P/N :	C _n uF	Diameter D mm	Length L mm	ESR mohm 100khz	ESL nH	dv/dt v/us	Peak Current I _{peak} A	Max. Amp 70C	Max. Amp 85C	Max. Amp 105C	d (mm)
STG-01A255K2500D	2.5	65	280	2.8	33	540	1300	40	35	25	M6
STG-01A305K2500D	3	65	280	2.6	33	540	1600	50	40	30	M6
STG-01A405K2500D	4	65	280	2.9	33	540	2100	50	40	30	M6
STG-01A505K2500D	5	65	280	2.6	33	540	2700	60	50	40	M6
STG-01A605K2500D	6	90	280	2.3	33	540	3200	70	60	50	M6
STG-01A805K2500D	8	90	280	2.1	33	540	4300	70	60	50	M6

STG-A V_{ndc} = 2600V / V_{rms} = 1000Vac / V_{peak} = 1450V 10s / V_{surge} = 3900V 30s/day

P/N :	C _n uF	Diameter D mm	Length L mm	ESR mohm 100khz	ESL nH	dv/dt v/us	Peak Current I _{peak} A	Max. Amp 55C	Max. Amp 70C	Max. Amp 85C	d (mm)
STG-A1755J2600D	1.75	65	89	2.5	11	1280	2200	30	25	21	M6
STG-A205J2600D	2	65	89	2.2	11	1280	2500	30	25	21	M6
STG-A225J2600D	2.2	65	89	2.2	11	1280	2800	36	30	25	M6

STG-01A V_{ndc} = 2700V / V_{rms} = 770Vac / V_{peak} = 1100V 10s / V_{surge} = 4350V 30s/day

P/N :	C _n uF	Diameter D mm	Length L mm	ESR mohm 100khz	ESL nH	dv/dt v/us	Peak Current I _{peak} A	Max. Amp 70C	Max. Amp 85C	Max. Amp 105C	d (mm)
STG-01A205K2700D	2	65	160	1.6	50	1000	2000	60	50	25	M6
STG-01A255K2700D	2.5	65	190	1.6	60	800	2000	60	50	25	M6
STG-01A335K2700D	3.3	65	220	1.5	75	600	1980	60	50	25	M6
STG-01A405K2700D	4	65	220	1.3	75	600	2400	65	55	30	M6

STG-01A V_{ndc} = 3000V / V_{rms} = 1000Vac / V_{peak} = 1500V 10s / V_{surge} = 4900V 10s/day

P/N :	C _n uF	Diameter D mm	Length L mm	ESR mohm 100khz	ESL nH	dv/dt v/us	Peak Current I _{peak} A	Max. Amp 70C	Max. Amp 85C	Max. Amp 105C	d (mm)
STG-01A205K3000D	2	90	280	2.6	33	800	1600	40	30	22	M6
STG-01A255K3000D	2.5	90	280	2.7	33	800	2000	40	30	22	M6
STG-01A305K3000D	3	90	280	2.6	33	800	2400	50	40	25	M6
STG-01A405K3000D	4	90	280	2.3	33	800	3200	60	50	40	M6
STG-01A505K3000D	5	90	280	2.1	33	800	4000	70	60	45	M6

STG-A V_{ndc} = 3000V / V_{rms} = 1100Vac / V_{peak} = 1600V 10s / V_{surge} = 4300V 30s/day

P/N :	C _n uF	Diameter D mm	Length L mm	ESR mohm 100khz	ESL nH	dv/dt v/us	Peak Current I _{peak} A	Max. Amp 45C	Max. Amp 55C	Max. Amp 85C	d (mm)
STG-A225J3000D	2.2	65	92	4.0	55	1180	2600	35	30	25	M6
STG-A335J3000D	3.3	65	92	4.0	55	1180	3900	50	45	40	M6

For other Capacitance, Voltage, dv/dt, Peak Current and RMS Current not listed, please contact us for a suggestion.

STG-01A V_{ndc} = 3100V / V_{rms} = 900Vac / V_{peak} = 1300V 10s / V_{surge} = 5000V 30s/day

P/N :	C _n uF	Diameter D mm	Length L mm	ESR mohm 100khz	ESL nH	dv/dt v/us	Peak Current I _{peak} A	Max. Amp 70C	Max. Amp 85C	Max. Amp 105C	d (mm)
STG-01A155K3100D	1.5	65	160	1.6	50	1320	1980	50	40	20	M6
STG-01A205K3100D	2	65	190	1.5	60	1000	2000	50	40	20	M6
STG-01A225K3100D	2.2	65	190	1.3	60	1000	2200	50	40	20	M6
STG-01A255K3100D	2.5	65	190	1.2	60	1000	2500	60	50	25	M6
STG-01A305K3100D	3	65	220	1.3	75	800	2400	60	50	25	M6
STG-01A335K3100D	3.3	90	220	1.2	75	800	2640	65	55	27	M6
STG-01A355K3100D	3.5	90	220	1.1	75	800	2800	65	55	27	M6

STG-01A V_{ndc} = 3200V / V_{rms} = 780Vac / V_{peak} = 1100V 10s / V_{surge} = 4800V 30s/day

P/N :	C _n uF	Diameter D mm	Length L mm	ESR mohm 100khz	ESL nH	dv/dt v/us	Peak Current I _{peak} A	Max. Amp 55C	Max. Amp 70C	Max. Amp 85C	Max. Amp 105C	d (mm)
STG-01A254K3200D	0.25	65	93	4.5	32	1450	360	17	12.5	7.5	4.62	M6
STG-01A334K3200D	0.33	65	93	4.0	32	1450	480	17	12.5	8	4.5	M6
STG-01A504K3200D	0.5	65	93	4.0	32	1450	720	25	20	12	6.9	M6
STG-01A754K3200D	0.75	65	93	3.5	32	1450	1000	40	30	18	10.4	M6
STG-01A105K3200D	1	65	115	3.5	40	800	800	30	23	13.5	7.7	M6
STG-01A155K3200D	1.5	65	131	3.0	45	650	975	35	26	16	8.9	M6

STG-01A V_{ndc} = 3500V / V_{rms} = 920Vac / V_{peak} = 1300V 10s / V_{surge} = 5300V 30s/day

P/N :	C _n uF	Diameter D mm	Length L mm	ESR mohm 100khz	ESL nH	dv/dt v/us	Peak Current I _{peak} A	Max. Amp 55C	Max. Amp 70C	Max. Amp 85C	Max. Amp 105C	d (mm)
STG-01A254K3500D	0.25	65	93	5.0	32	1900	470	16	12.5	8	5	M6
STG-01A334K3500D	0.33	65	93	4.5	32	1900	620	25	20	12	8	M6
STG-01A504K3500D	0.5	65	93	4.0	32	1900	950	40	30	18	11	M6
STG-01A754K3500D	0.75	65	115	3.5	40	1100	820	30	23	13	8	M6
STG-01A105K3500D	1	65	133	3.5	45	825	820	35	26	16	10	M6

STG-01A V_{ndc} = 3600V / V_{rms} = 1100Vac / V_{peak} = 1600V 10s / V_{surge} = 5760V 30s/day

P/N :	C _n uF	Diameter D mm	Length L mm	ESR mohm 100khz	ESL nH	dv/dt v/us	Peak Current I _{peak} A	Max. Amp 70C	Max. Amp 85C	Max. Amp 105C	d (mm)
STG-01A155K3600D	1.5	65	200	1.6	70	1355	2000	60	50	25	M6
STG-01A205K3600D	2	65	235	1.7	85	1000	2000	60	50	25	M6
STG-01A255K3600D	2.5	65	280	1.6	100	800	2000	60	50	25	M6
STG-01A305K3600D	3	65	280	1.3	100	800	2400	70	60	30	M6

STG-01A V_{ndc} = 4000V / V_{rms} = 1200Vac / V_{peak} = 1700V 10s / V_{surge} = 6000V 30s/day

P/N :	C _n uF	Diameter D mm	Length L mm	ESR mohm 100khz	ESL nH	dv/dt v/us	Peak Current I _{peak} A	Max. Amp 70C	Max. Amp 85C	Max. Amp 105C	d (mm)
STG-01A155K4000D-V1	1.5	90	280	2.5	33	1280	1900	35	30	20	M6
STG-01A155K4000D-V2	1.5	65	280	2.5	33	1280	1900	30	25	18	M6
STG-01A205K4000D-V1	2	90	280	2.3	33	1280	2500	50	40	25	M6
STG-01A205K4000D-V2	2	65	280	2.3	33	1280	2500	40	30	20	M6
STG-01A255K4000D-V1	2.5	90	280	2.1	33	1280	3200	60	50	35	M6
STG-01A255K4000D-V2	2.5	90	280	2.1	33	1280	3200	50	40	30	M6
STG-01A305K4000D-V1	3	90	280	2.2	33	1280	3800	60	50	35	M6
STG-01A305K4000D-V2	3	90	280	2.0	33	1280	3800	60	50	35	M6

STG-01A V_{ndc} = 4500V / V_{rms} = 1350Vac / V_{peak} = 1950V 10s / V_{surge} = 7200V 30s/day

P/N :	C _n uF	Diameter D mm	Length L mm	ESR mohm 100khz	ESL nH	dv/dt v/us	Peak Current I _{peak} A	Max. Amp 70C	Max. Amp 85C	Max. Amp 105C	d (mm)
STG-01A254K4500D	0.25	65	130	2.1	35	5000	1200	30	25	15	M6
STG-01A504K4500D	0.5	65	160	1.8	50	2900	1400	30	25	15	M6
STG-01A754K4500D	0.75	65	160	1.3	50	2900	2100	50	40	23	M6
STG-01A105K4500D	1	65	190	1.2	60	2200	2200	50	40	23	M6
STG-01A125K4500D	1.2	65	220	1.3	75	1700	2000	50	40	23	M6
STG-01A155K4500D	1.5	90	220	1.1	75	1700	2500	55	45	27	M6

STG-01A V_{ndc} = 5000V / V_{rms} = 1400Vac / V_{peak} = 2000V 10s / V_{surge} = 7500V 30s/day

P/N :	C _n uF	Diameter D mm	Length L mm	ESR mohm 100khz	ESL nH	dv/dt v/us	Peak Current I _{peak} A	Max. Amp 70C	Max. Amp 85C	Max. Amp 105C	d (mm)
STG-01A155K5000D	1.5	90	280	2.4	33	1850	2700	35	30	20	M6
STG-01A205K5000D	2	90	280	2.2	33	1850	3700	45	40	25	M6
STG-01A255K5000D	2.5	90	280	1.9	33	1850	4600	60	50	35	M6

For other Capacitance, Voltage, dv/dt, Peak Current and RMS Current not listed, please contact us for a suggestion.

Headquarter & Production : HK Film Capacitor Ltd

Worldwide Sales Office : HKFC Industrial Pty Ltd

<https://www.hkfc-industrial.com> email : enquiry@hkfc-industrial.com

STG-01A V_{ndc} = 5300V / V_{rms} = 1600Vac / V_{peak} = 2300V 10s / V_{surge} = 8500V 30s/day

P/N :	C _n uF	Diameter D mm	Length L mm	ESR mohm 100khz	ESL nH	dv/dt v/us	Peak Current I _{peak} A	Max. Amp 70C	Max. Amp 85C	Max. Amp 105C	d (mm)
STG-01A254K5300D	0.25	65	130	1.6	35	7000	1700	40	30	15	M6
STG-01A504K5300D	0.5	65	160	1.3	50	3900	1900	40	30	20	M6
STG-01A754K5300D	0.75	65	220	1.6	75	2300	1700	40	30	20	M6
STG-01A105K5300D	1	90	220	1.2	75	2300	2300	45	35	25	M6

STG-A V_{ndc} = 5800V / V_{rms} = 2000Vac / V_{peak} = 2850V 10s / V_{surge} = 8700V 30s/day

P/N :	C _n uF	Diameter D mm	Length L mm	ESR mohm 100khz	ESL nH	dv/dt v/us	Peak Current I _{peak} A	Max. Amp 55C	Max. Amp 70C	Max. Amp 85C	d (mm)
STG-A334J5800D	0.33	65	99	3.30	8.5	4860	1600	30	25	21	M6

For other Capacitance, Voltage, dv/dt, Peak Current and RMS Current not listed, please contact us for a suggestion.